

Pignoni **Temprati** per catene a rulli ISO

DIN 8188 – ISO 606

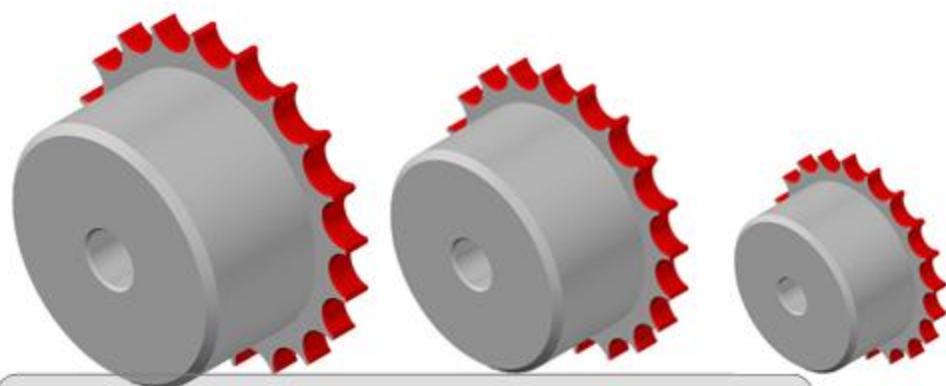

Catalogo tecnico 2009

-Trasmissioni industriali s.a.s. -

Via lago di Annone n°15 36015 Schio VI - Italy – Tel: 0445-500142 fax: 0445-500018

Mail: info@trasmissioniindustriali.com Site web: www.trasmissioniindustriali.com



PIGNONI SEMPLICI TEMPERATI AD INDUZIONE PER CATENE A RULLI - DIN 8187 - ISO 606
SIMPLEX SPROCKETS WITH HARDENED TEETH FOR ROLLER CHAINS - DIN 8187 - ISO 606

3/8" x 7/32"

9,525 x 5,72 mm
Rullo 6,35 mm
06B - 1

B1	C	r3
5,3	1	10

Materiale C 43 UNI 7847

Z	de	dp	dm	D1	A	Kg.
13	43,5	39,80	28	8	25	0,13
14	46,5	42,80	31	8	25	0,16
15	49,5	45,81	34	8	25	0,19
16	52,5	48,82	37	10	28	0,24
17	55,5	51,83	40	10	28	0,28
18	58,6	54,85	43	10	28	0,33
19	61,6	57,87	45	10	28	0,36
20	64,6	60,89	46	10	28	0,39
21	67,6	63,91	48	12	28	0,42
22	70,6	66,93	50	12	28	0,46
23	73,7	69,95	52	12	28	0,50
24	76,7	72,97	54	12	28	0,54
25	79,7	76,00	57	12	28	0,60
30	94,8	92,12	60	12	30	0,72

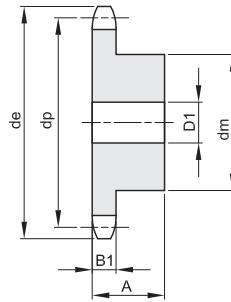
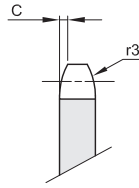

1/2" x 5/16"

12,7 x 7,75 mm
Rullo 8,51 mm
08B - 1

B1	C	r3
7,2	1,3	1,3

Materiale C 43 UNI 7847

Z	de	dp	dm	D1	A	Kg.
12	53,9	49,07	33	10	28	0,21
13	57,9	53,06	37	10	28	0,26
14	61,9	57,07	41	10	28	0,32
15	65,9	61,09	45	10	28	0,38
16	69,9	65,10	50	12	28	0,46
17	74,0	69,11	52	12	28	0,51
18	78,0	73,14	56	12	28	0,59
19	82,0	77,16	60	12	28	0,67
20	86,0	81,19	64	12	28	0,76
21	90,1	85,22	68	14	28	0,85
22	94,1	89,24	70	14	28	0,91
23	98,1	93,27	70	14	28	0,94
24	102,1	97,29	70	14	28	0,98
25	106,2	101,33	70	14	28	1,01
30	126,3	121,50	80	16	30	1,46

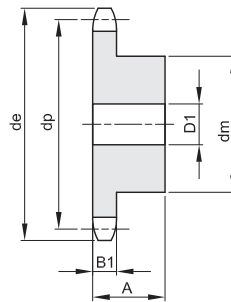
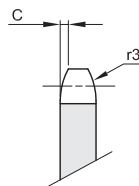



PIGNONI SEMPLICI TEMPERATI AD INDUZIONE PER CATENE A RULLI - DIN 8187 - ISO 606
SIMPLEX SPROCKETS WITH HARDENED TEETH FOR ROLLER CHAINS - DIN 8187 - ISO 606

1" x 17,02 mm
25,4 x 17,02 mm
Rullo 15,88 mm
16B - 1

B1	C	r3
16,2	2,5	26

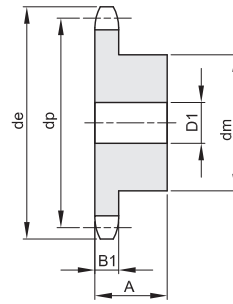
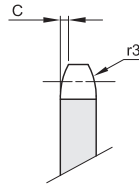

Materiale C 43 UNI 7847

Z	de	dp	dm	D1	A	Kg.
12	109,7	98,14	69	16	40	1,43
13	117,7	106,12	78	16	40	1,77
14	125,7	114,15	84	16	40	2,08
15	133,7	122,17	92	16	40	2,46
16	141,8	130,20	100	20	45	3,14
17	149,8	138,22	100	20	45	3,34
18	157,8	146,28	100	20	45	3,56
19	165,9	154,33	100	20	45	3,78
20	173,9	162,38	100	20	45	4,03
21	182,0	170,43	110	20	50	5,01
22	190,1	178,48	110	20	50	5,28
23	198,1	186,53	110	20	50	5,56
24	206,1	194,59	110	20	50	5,86
25	214,2	202,65	110	20	50	6,16
30	254,6	243,00	120	20	50	8,38

Z	de	dp	dm	D1	A	Kg.

