

Pignoni e corone per catene da trasporto

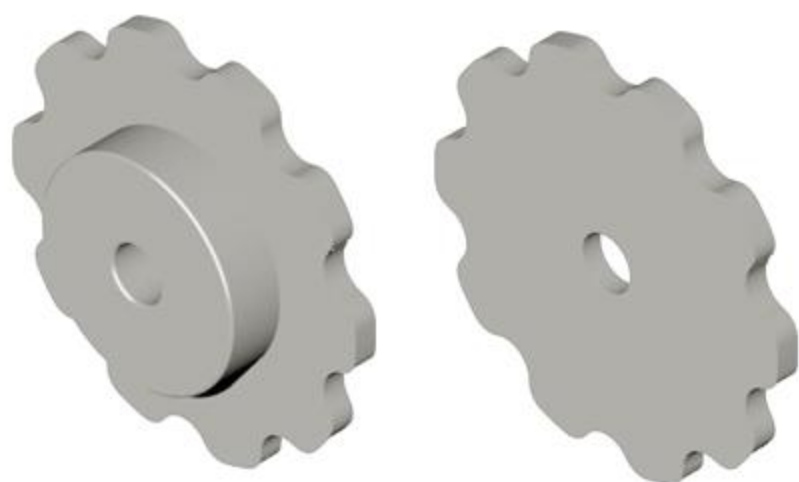

Catalogo tecnico 2009

-Trasmissioni industriali s.a.s. -

Via lago di Annone n°15 36015 Schio VI - Italy – Tel: 0445-500142 fax: 0445-500018

Mail: info@trasmissioniindustriali.com Site web: www.trasmissioniindustriali.com

CORONE PER CATENE TRASPORTO PLATE WHEELS FOR CONVEYOR CHAINS

PASSO 50 RULLO 25

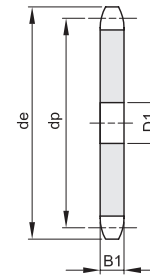
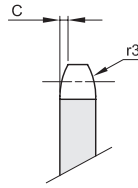

B1	C	r3
10,5	3	50

Materiale: Fe

Z	de	dp	D1	Kg.	Z	de	dp	D1	Kg.
6	121,0	100,00	20	0,55	21	356,5	335,45	30	7,39
7	136,0	115,24	20	0,76	22	372,5	351,35	30	7,88
8	151,5	130,65	20	0,92	23	388,0	367,20	30	8,15
9	167,0	146,20	20	1,15	24	404,0	383,05	30	8,68
10	183,0	161,80	25	1,52	25	420,0	398,95	30	9,66
11	198,5	177,50	25	1,86	28	467,5	446,55	30	13,15
12	214,0	193,20	25	2,20	30	499,5	478,35	30	14,82
13	230,0	208,95	25	2,56	35	579,0	557,80	30	19,10
14	245,5	224,70	25	2,99	38	626,5	605,45	30	21,50
15	261,5	240,45	25	3,40					
16	277,5	256,30	30	3,94					
17	293,0	272,11	30	4,73					
18	309,0	287,95	30	4,94					
19	325,0	303,80	30	6,00					
20	340,5	319,60	30	6,10					

PASSO 50 RULLO 31

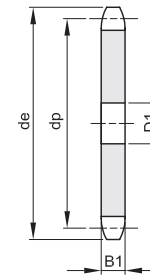
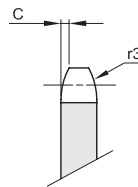

B1	C	r3
13,5	3	50

Materiale: Fe

Z	de	dp	D1	Kg.	Z	de	dp	D1	Kg.
6	120,0	100,00	20	0,61	21	355,5	335,45	30	8,65
7	135,0	115,24	20	0,86	22	371,5	351,35	30	9,44
8	150,5	130,65	20	1,16	23	387,0	367,20	30	10,28
9	166,0	146,20	20	1,48	24	403,0	383,05	30	11,25
10	182,0	161,80	25	1,83	25	419,0	398,95	30	12,30
11	197,5	177,50	25	2,27	26	435,0	414,80	30	13,34
12	213,0	193,20	25	2,72	28	466,5	446,55	30	15,52
13	229,0	208,95	25	3,21	30	498,5	478,35	30	17,95
14	244,5	224,70	25	3,71	32	530,0	510,10	30	20,46
15	260,5	240,45	25	4,33	38	625,5	605,45	30	26,60
16	276,5	256,30	30	4,94					
17	292,0	272,11	30	5,58					
18	308,0	287,95	30	6,30					
19	324,0	303,80	30	7,04					
20	339,5	319,60	30	7,82					

CORONE PER CATENE TRASPORTO

PLATE WHEELS FOR CONVEYOR CHAINS

PASSO 50,8 RULLO 30

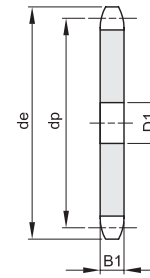
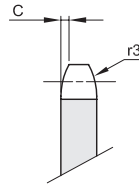

B1	C	r3
8,8	3	50

Materiale: Acciaio C 43

Z	de	dp	D1	Kg.	Z	de	dp	D1	Kg.
8	149,0	132,74	20	0,67					
10	182,0	164,39	25	1,22					
12	214,0	196,27	25	1,81					
14	247,0	228,29	25	2,49					
16	279,0	260,39	30	3,24					

PASSO 75 RULLO 25

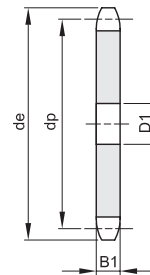
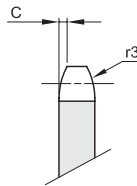

B1	C	r3
10,5	3	50

Materiale: Fe

Z	de	dp	D1	Kg.	Z	de	dp	D1	Kg.
8	211,0	195,98	25	2,47					
10	258,0	242,70	25	3,77					

PASSO 75 RULLO 31

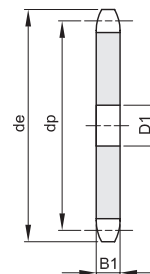
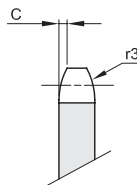

B1	C	r3
13,5	3	50

Materiale: Fe

Z	de	dp	D1	Kg.	Z	de	dp	D1	Kg.
6	168,0	150,00	25	1,68	13	333,0	313,42	30	7,80
8	215,0	195,98	25	2,94	14	357,0	337,05	30	9,12
9	238,0	219,30	25	3,78	15	380,0	360,73	30	10,42
10	261,0	242,70	30	4,50	16	404,0	384,45	30	11,98
11	286,0	266,25	30	5,57	20	499,0	479,40	30	18,35
12	309,0	289,80	30	6,70	21	523,0	503,17	30	20,62

CORONE PER CATENE TRASPORTO

PLATE WHEELS FOR CONVEYOR CHAINS

PASSO 100
RULLO 31

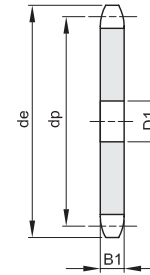
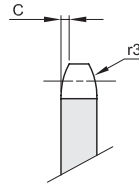

B1	C	r3
13,5	3	50

Materiale: Fe

Z	de	dp	D1	Kg.
6	218,0	200,00	25	3,32
7	249,0	230,48	25	4,32
8	280,0	261,31	30	5,50
9	311,0	292,40	30	6,95
10	342,0	323,61	30	8,57
11	375,0	354,95	30	10,29
12	406,0	386,40	30	12,45
13	437,0	417,90	30	14,45
14	469,0	449,40	30	16,84
15	500,0	480,97	30	19,36
16	532,0	512,60	30	21,76

Z	de	dp	D1	Kg.

PASSO 100
RULLO 40

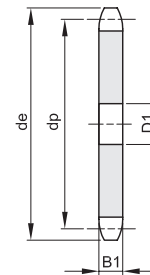
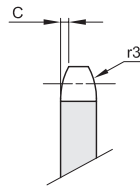

B1	C	r3
20	3	50

Materiale: Fe

Z	de	dp	D1	Kg.
6	220,0	200,00	25	4,54
7	251,0	230,48	25	6,10
8	283,0	261,31	30	7,87
9	314,0	292,40	30	9,94
10	345,0	323,61	30	12,25
11	378,0	354,95	30	14,72
12	409,0	386,40	30	17,48
13	441,0	417,90	30	20,90

Z	de	dp	D1	Kg.

PASSO 50 RULLO 25

B1	C	r3
10,5	3	50

Materiale: Fe

Z	de	dp	dm	D1	A	Kg.
6	121,0	100,00	58	20	40,5	1,11
7	136,0	115,24	58	20	40,5	1,37
8	151,5	130,65	58	20	40,5	1,55
9	167,0	146,20	58	20	40,5	1,89
10	183,0	161,80	88	25	45,5	3,10
11	198,5	177,50	88	25	45,5	3,44
12	214,0	193,20	88	25	45,5	3,79
13	230,0	208,95	88	25	45,5	4,17
14	245,5	224,70	88	25	45,5	4,63
15	261,5	240,45	88	25	45,5	5,09
16	277,5	256,30	118	30	60,5	8,26
17	293,0	272,11	118	30	60,5	9,10
18	309,0	287,95	118	30	60,5	9,26
19	325,0	303,80	118	30	60,5	10,32
20	340,5	319,60	118	30	60,5	10,42

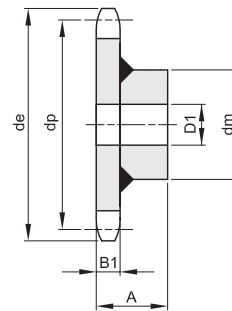
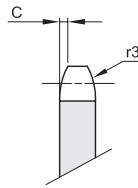

PASSO 50 RULLO 31

B1	C	r3
13,5	3	50

Materiale: Fe

Z	de	dp	dm	D1	A	Kg.
6	120,0	100,00	58	20	43,5	1,18
7	135,0	115,24	58	20	43,5	1,44
8	150,5	130,65	58	20	43,5	1,72
9	166,0	146,20	58	20	43,5	2,05
10	182,0	161,80	88	25	48,5	3,40
11	197,5	177,50	88	25	48,5	3,80
12	213,0	193,20	88	25	48,5	4,30
13	229,0	208,95	88	25	48,5	4,78
14	244,5	224,70	88	25	48,5	5,37
15	260,5	240,45	88	25	48,5	5,98
16	276,5	256,30	118	30	63,5	9,05
17	292,0	272,11	118	30	63,5	9,60
18	308,0	287,95	118	30	63,5	10,30
19	324,0	303,80	118	30	63,5	11,10
20	339,5	319,60	118	30	63,5	11,90

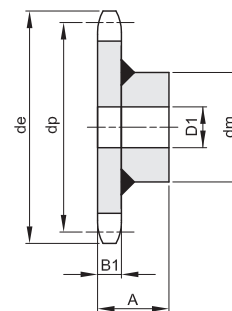
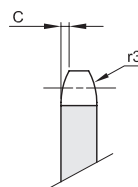

Z	de	dp	dm	D1	A	Kg.
21	356,5	335,45	118	30	60,5	11,71
22	372,5	351,35	118	30	60,5	12,20
23	388,0	367,20	118	30	60,5	12,47
24	404,0	383,05	118	30	60,5	13,00
25	420,0	398,95	118	30	60,5	13,98
28	467,5	446,55	133	30	62	18,62
30	499,5	478,35	133	30	62	20,29
35	579,0	557,80	133	30	62	24,57
38	626,5	605,45	133	30	62	26,97

Z	de	dp	dm	D1	A	Kg.
21	355,5	335,45	118	30	63,5	12,75
22	371,5	351,35	118	30	63,5	13,54
23	387,0	367,20	118	30	63,5	14,38
24	403,0	383,05	118	30	63,5	15,35
25	419,0	398,95	118	30	63,5	16,40
26	435,0	414,80	133	30	65	18,81
28	466,5	446,55	133	30	65	21,00
30	498,5	478,35	133	30	65	23,42
32	530,0	510,10	133	30	65	25,93
38	625,5	605,45	133	30	65	32,10

PASSO 50,8 RULLO 30

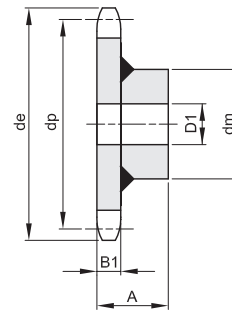
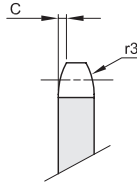

B1	C	r3
8,8	3	50

Materiale: Acciaio C 43

Z	de	dp	dm	D1	A	Kg.
8	149,0	132,74	58	20	39	1,35
10	182,0	164,39	88	25	44	2,85
12	214,0	196,27	88	25	44	3,37
14	247,0	228,29	88	25	44	4,08
16	279,0	260,39	118	30	59	7,34

Z	de	dp	dm	D1	A	Kg.

PASSO 75 RULLO 25

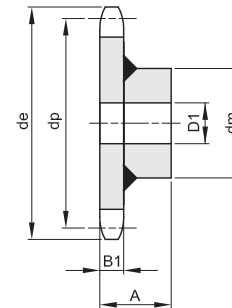
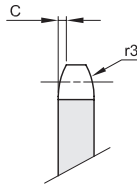

B1	C	r3
10,5	3	50

Materiale: Fe

Z	de	dp	dm	D1	A	Kg.
8	211,0	195,98	88	25	45,5	4,07
10	258,0	242,70	118	25	60,5	7,87

Z	de	dp	dm	D1	A	Kg.

PASSO 75 RULLO 31

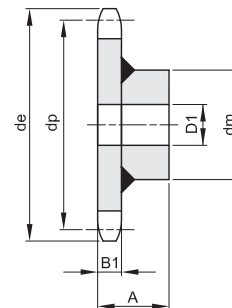
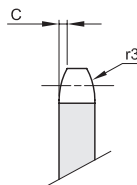

B1	C	r3
13,5	3	50

Materiale: Fe

Z	de	dp	dm	D1	A	Kg.
6	168,0	150,00	88	25	48,5	3,26
8	215,0	195,98	88	25	48,5	4,52
9	238,0	219,30	88	25	48,5	5,36
10	261,0	242,70	118	30	63,5	8,70
11	286,0	266,25	118	30	63,5	9,60
12	309,0	289,80	118	30	63,5	10,73

Z	de	dp	dm	D1	A	Kg.
13	333,0	313,42	118	30	63,5	11,83
14	357,0	337,05	118	30	63,5	13,15
15	380,0	360,73	118	30	63,5	14,45
16	404,0	384,45	133	30	65	17,43
20	499,0	479,40	133	30	65	23,80
21	523,0	503,17	133	30	65	26,07

PIGNONI PER CATENE TRASPORTO SPROCKETS FOR CONVEYOR CHAINS

**PASSO 100
RULLO 31**

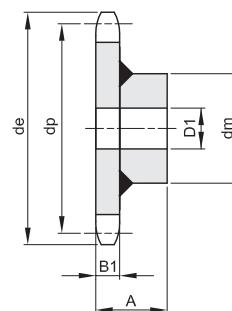
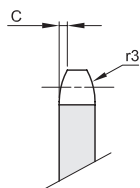

B1	C	r3
----	---	----

13,5	3	50
------	---	----

Materiale: Fe

Z	de	dp	dm	D1	A	Kg.
6	218,0	200,00	88	25	48,5	4,80
7	249,0	230,48	88	25	48,5	5,80
8	280,0	261,31	118	30	63,5	9,67
9	311,0	292,40	118	30	63,5	10,95
10	342,0	323,61	118	30	63,5	12,63
11	375,0	354,95	118	30	63,5	14,34
12	406,0	386,40	118	30	63,5	16,51
13	437,0	417,90	118	30	63,5	18,51
14	469,0	449,40	118	30	63,5	20,93
15	500,0	480,97	118	30	63,5	23,42
16	532,0	512,60	133	30	65,0	27,16

Z	de	dp	dm	D1	A	Kg.

**PASSO 100
RULLO 40**

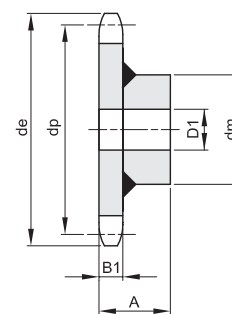
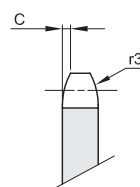

B1	C	r3
----	---	----

20	3	50
----	---	----

Materiale: Fe

Z	de	dp	dm	D1	A	Kg.
6	220,0	200,00	118	25	70	8,64
7	251,0	230,48	118	25	70	10,20
8	283,0	261,31	118	30	70	11,97
9	314,0	292,40	118	30	70	14,04
10	345,0	323,61	118	30	70	16,35
11	378,0	354,95	118	30	70	18,82
12	409,0	386,40	118	30	70	21,58
13	441,0	417,90	118	30	70	25,00

Z	de	dp	dm	D1	A	Kg.